

NAFS系列螺纹副

说明:

卓立汉光在原有 ACFS 系列螺纹副的基础上, 进一步提升制造工艺, 开发出螺距为 0.1mm/0.2mm 的 NAFS 系列螺纹副, 进一步提高灵敏度, 可以更加便捷的进行非定量精密调节。

配套内六角扳手。

命名规则:

NAFS 6 - M4 - 0.2P

产品代码:
NAFS (New Adjustable
Fine Screw) : 微调螺纹副

调节行程:
6: 6.5mm
13: 13mm

螺纹:
M4: 4mm
M6: 6mm

螺距:
0.1P: 0.1mm
0.2P: 0.2mm

尺寸图:

NAFS6-M4-0.1P

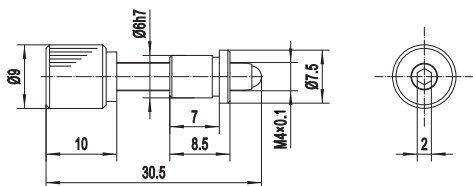

NAFS13-M4-0.1P

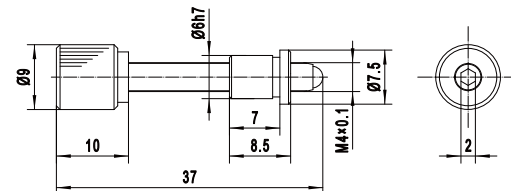

NAFS6-M6-0.1P

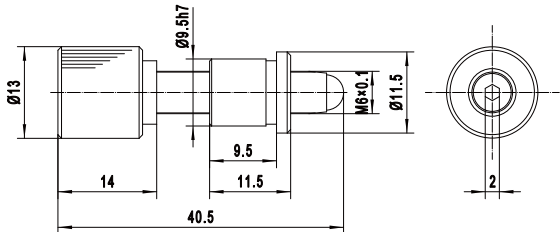

NAFS13-M6-0.1P

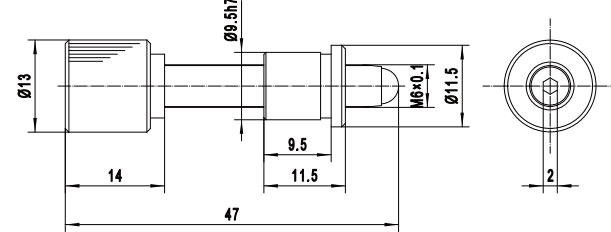

型号	NAFS6-M4-0.1P	NAFS13-M4-0.1P	NAFS6-M6-0.1P	NAFS13-M6-0.1P
有效行程(mm)	6	13	6	13
调节螺纹/螺距	M4×0.1		M6×0.1	
安装直径(mm)	φ6		φ9.5	
安装长度(mm)	7		9.5	
总长度(mm)	30.5	37	40.5	47
手轮直径(mm)	φ9		φ13	

注: 0.1P螺纹副使用寿命约为5000~10000mm (v=1rev/s时)。

NAFS6-M4-0.2P

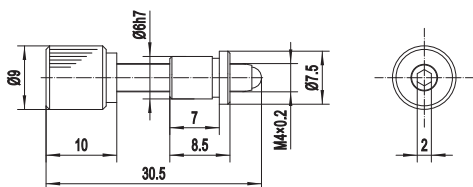

NAFS13-M4-0.2P

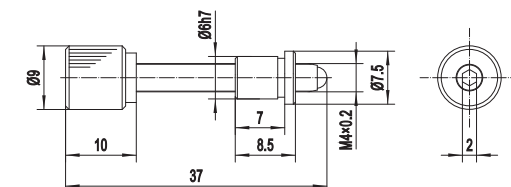

NAFS6-M6-0.2P

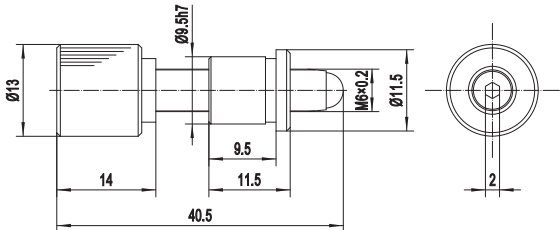

NAFS13-M6-0.2P

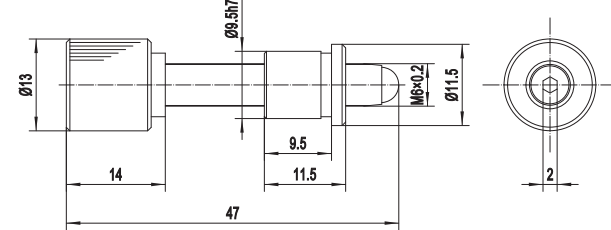

型号	NAFS6-M4-0.2P	NAFS13-M4-0.2P	NAFS6-M6-0.2P	NAFS13-M6-0.2P
有效行程(mm)	6	13	6	13
调节螺纹/螺距	M4×0.2		M6×0.2	
安装直径(mm)	φ6		φ9.5	
安装长度(mm)	7		9.5	
总长度(mm)	30.5	37	40.5	47
手轮直径(mm)	φ9		φ13	

AUS12.7-3.0

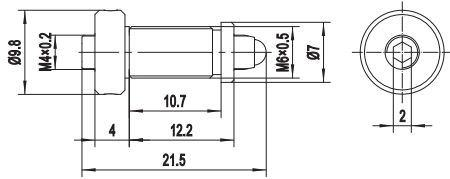

AUS25.4-3.0

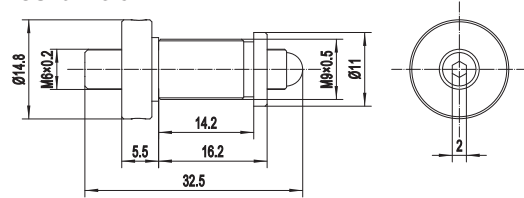

NLXY25.4-6.0

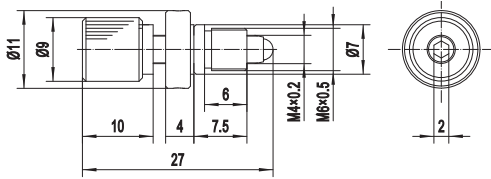

NLXY50.8-6.0

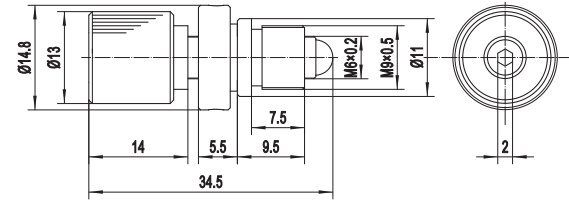

型号	AUS12.7-3.0	AUS25.4-3.0	NLXY25.4-6.0	NLXY50.8-6.0
有效行程(mm)	4	8.5	4	4
调节螺纹/螺距	M4×0.2	M6×0.2	M4×0.2	M6×0.2
安装尺寸(mm)	M6×0.5	M9×0.5	M6×0.5	M9×0.5
安装长度(mm)	10.5	14	6	7.5
总长度(mm)	21.5	32.5	27	34.5
手轮直径(mm)	/		φ 9	φ 13
锁紧	轴向锁紧			